

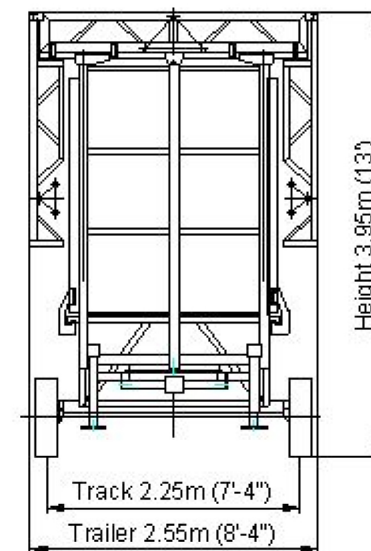

www.mobilestagemanufacturing.com
 100 Eads St. West Babylon, NY 11704
 (516) 882-5412
 Info@MobileStageManufacturing.com

Mass and Dimensions – Stagemobil XXL

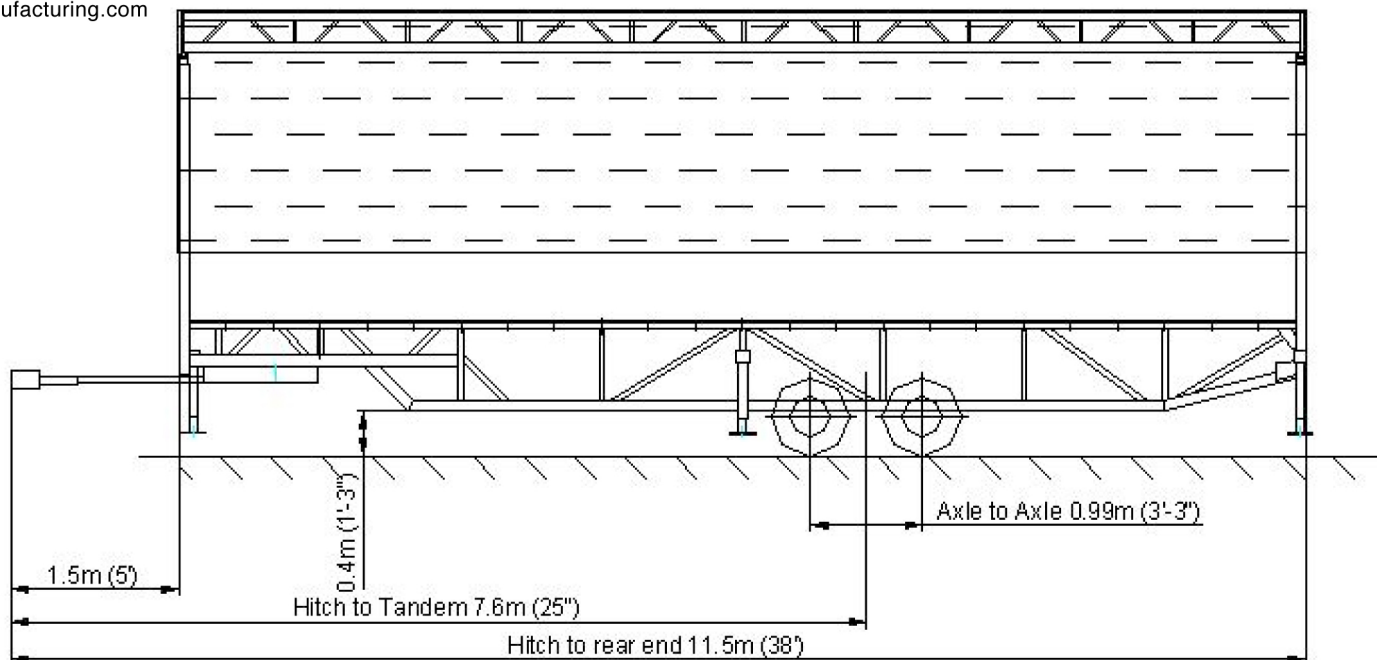

Note

1. Mass may vary depending of options.

Mass

kg

Lbs

Vehicle Mass	4000	8800
Net weight	3800	8360
Allowable Load on Axle	2500	5500

Standard: 2 axles

Stage specifications subject
 To change without notice
 Figures are within inch or
 cm to actual size

©2008 – Allrights reserved, Karl Eckart Fahrzeugbeu GmbH. Any and all forms of adaption or reproduction of this document including plans and drawings found herein, in whole or in part, are strictly forbidden without the written authorisation of Karl Eckart Fahrzeugbau GmbH.

Date: 2008-02-05
 Revision 0



www.mobilestagemanufacturing.com

100 Eads St. West Babylon, NY 11704

(516) 882-5412

Info@MobileStageManufacturing.com

Stagemobil XXL

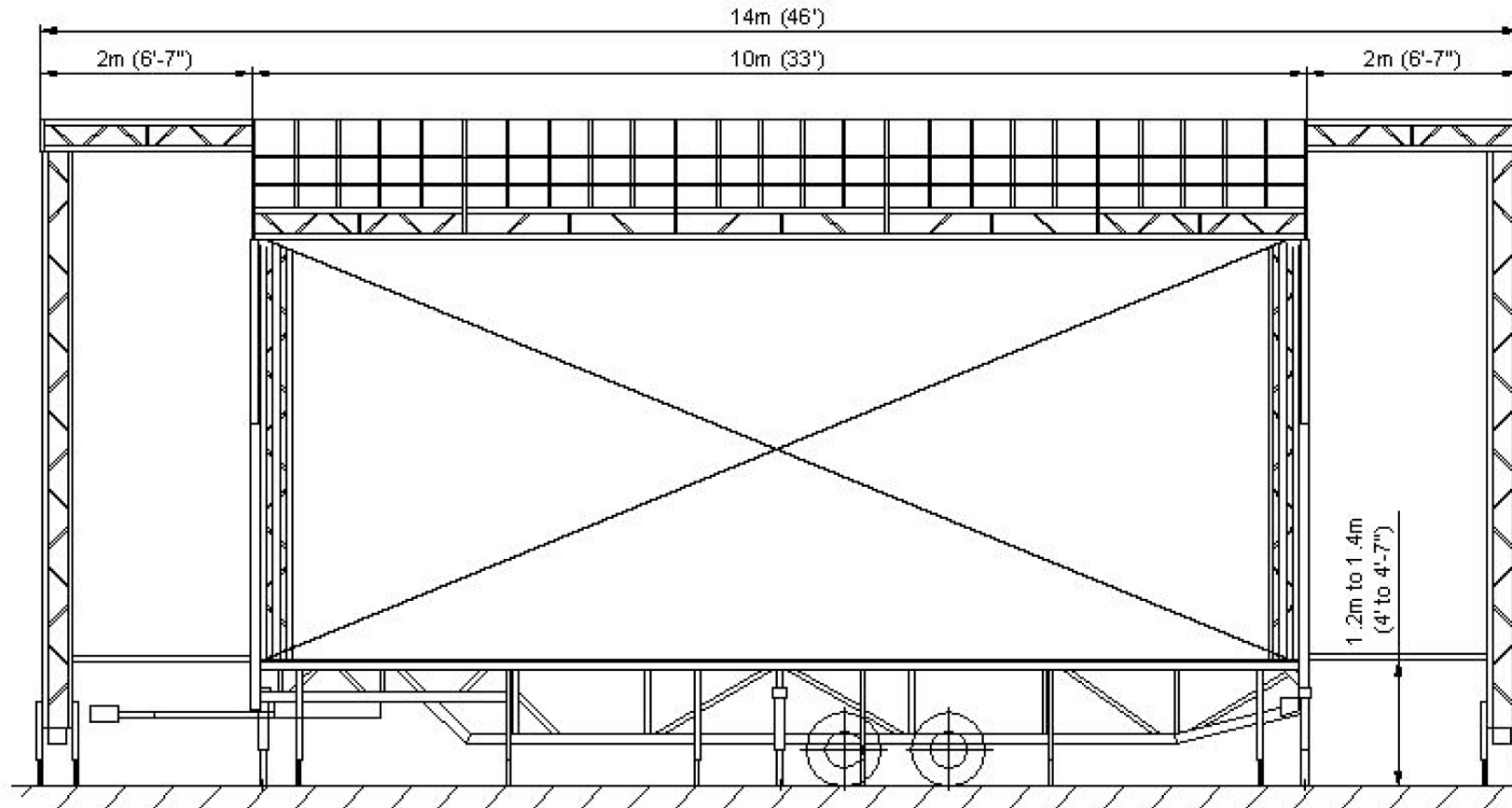

Front View

Stage specifications subject
To change without notice
Figures are within inch or
cm to actual size

©2008 – Allrights reserved, Karl Eckart Fahrzeugbeu GmbH. Any and all forms of adaption or reproduction of this document including plans and drawings found herein, in whole or in part, are strictly forbidden without the written authorisation of Karl Eckart Fahrzeugbau GmbH.

Date: 2008-02-05
Revision 0



www.mobilestagemanufacturing.com
 100 Eads St. West Babylon, NY 11704
 (516) 882-5412
 Info@MobileStageManufacturing.com

Stagemobil XXL

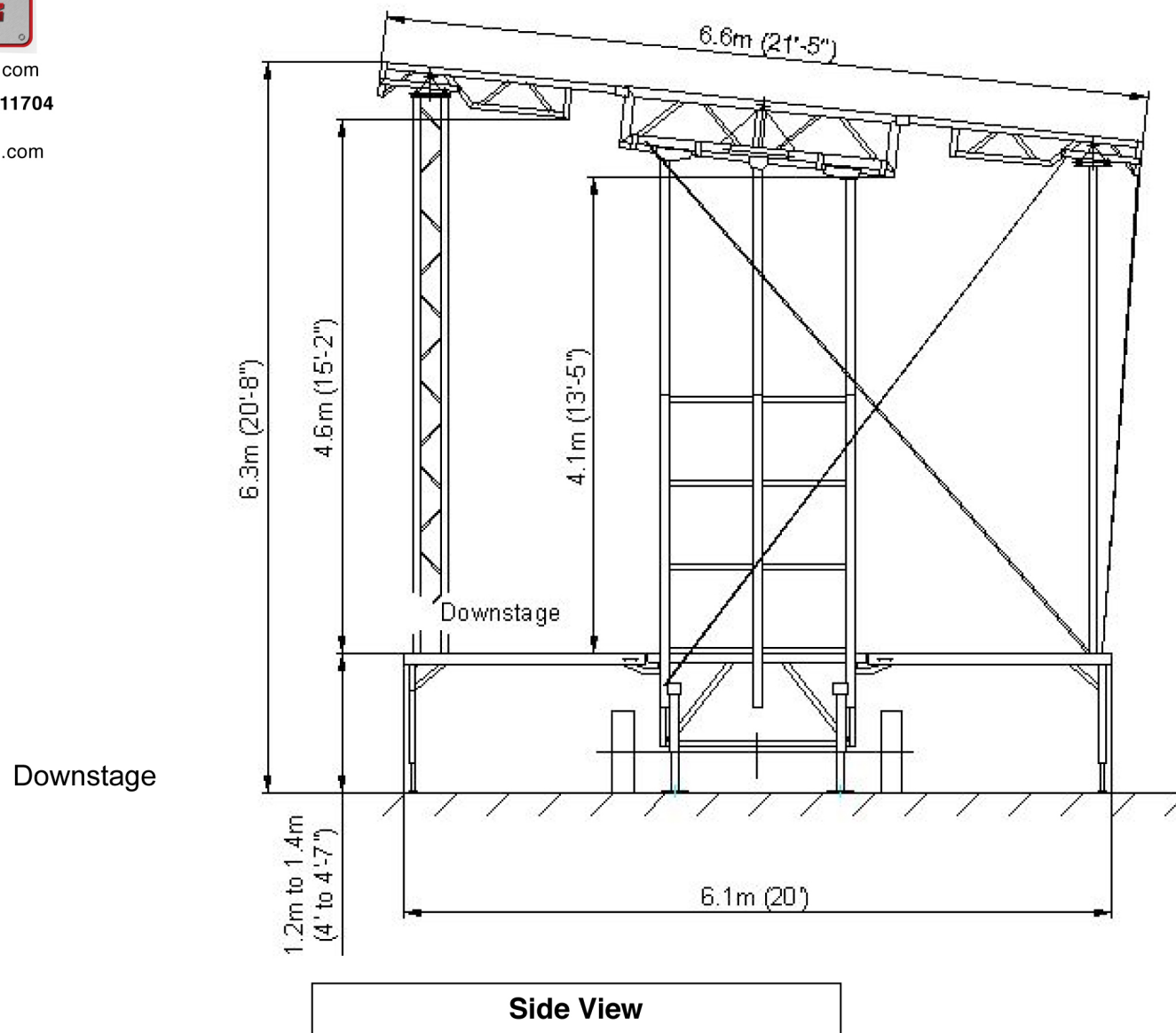

Stage specifications subject
 To change without notice
 Figures are within inch or
 cm to actual size

©2008 – Allrights reserved, Karl Eckart Fahrzeugbeu GmbH. Any and all forms of adaption or reproduction of this document including plans and drawings found herein, in whole or in part, are strictly forbidden without the written authorisation of Karl Eckart Fahrzeugbau GmbH.

Date: 2008-02-05
 Revision 0



www.mobilestagemanufacturing.com
100 Eads St. West Babylon, NY 11704
(516) 882-5412
Info@MobileStageManufacturing.com

Stagemobil XXL



Downstage
Capacity: 100 lbs/ft² (5 kN/m²)

Floor View

Stage specifications subject
To change without notice
Figures are within inch or
cm to actual size

©2008 – Allrights reserved, Karl Eckart Fahrzeugbeu GmbH. Any and all forms of adaption or reproduction of this document including plans and drawings found herein, in whole or in part, are strictly forbidden without the written authorisation of Karl Eckart Fahrzeugbau GmbH.

Date: 2008-02-05
Revision 0



www.mobilestagemanufacturing.com
100 Eads St. West Babylon, NY 11704
(516) 882-5412
Info@MobileStageManufacturing.com

Stagemobil XXL

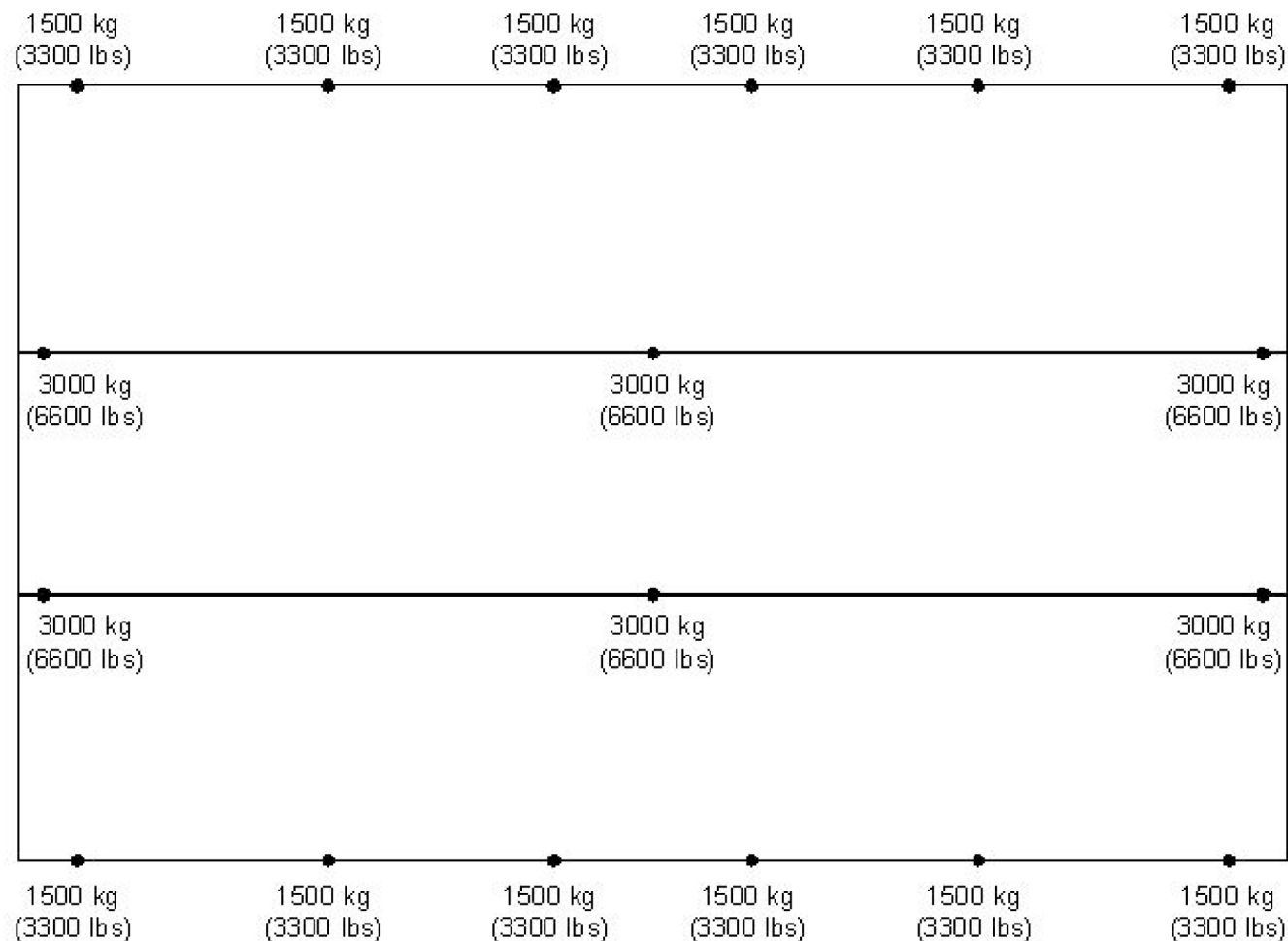

Downstage

Ground Support Capacity

● Floor stabilizers, extensions and leveling jacks.
*Nominal specifications subject to change with notice.

Stage specifications subject
To change without notice
Figures are within inch or
cm to actual size

©2008 – Allrights reserved, Karl Eckart Fahrzeugbeu GmbH. Any and all forms of adaption or reproduction of this document including plans
and drawings found herein, in whole or in part, are strictly forbidden without the written authorisation of Karl Eckart Fahrzeugbau GmbH.

Date: 2008-02-05
Revision 0



www.mobilestagemanufacturing.com
 100 Eads St. West Babylon, NY 11704
 (516) 882-5412
 Info@MobileStageManufacturing.com

Stagemobil XXL

LOAD BEARING TRUSSES

Total Maximum 350 kg (770 lbs)
 RIGGING PATTERNS
 T1-T3: USE P1 or P2 or P3

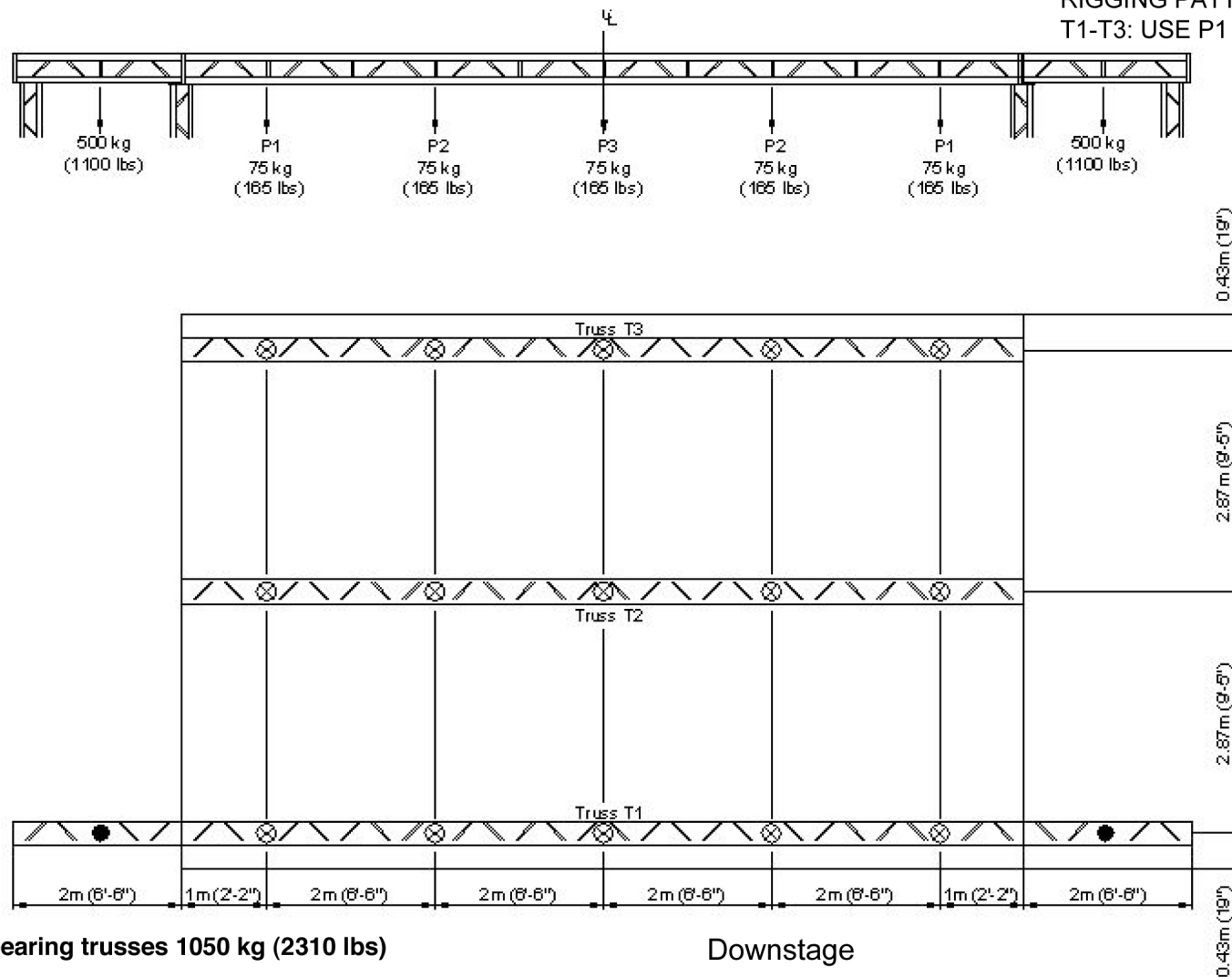

Maximum load bearing capacity of all 3 bearing trusses 1050 kg (2310 lbs)

Downstage

● Rigging point maximum capacity: 500 kg (1100 lbs)

⊗ Rigging point maximum capacity: 75 kg (165 lbs)

All loads should be evenly distributed.

Rigging Plan

Stage specifications subject
 To change without notice
 Figures are within inch or

©2008 – All rights reserved, Karl Eckart Fahrzeugbau GmbH. Any and all forms of adaption or reproduction of this document including plans and drawings found herein, in whole or in part, are strictly forbidden without the written authorisation of Karl Eckart Fahrzeugbau GmbH.

Date: 2008-02-05
 Revision 0